

How to reach the conference building, presentation rooms and Augusteum:

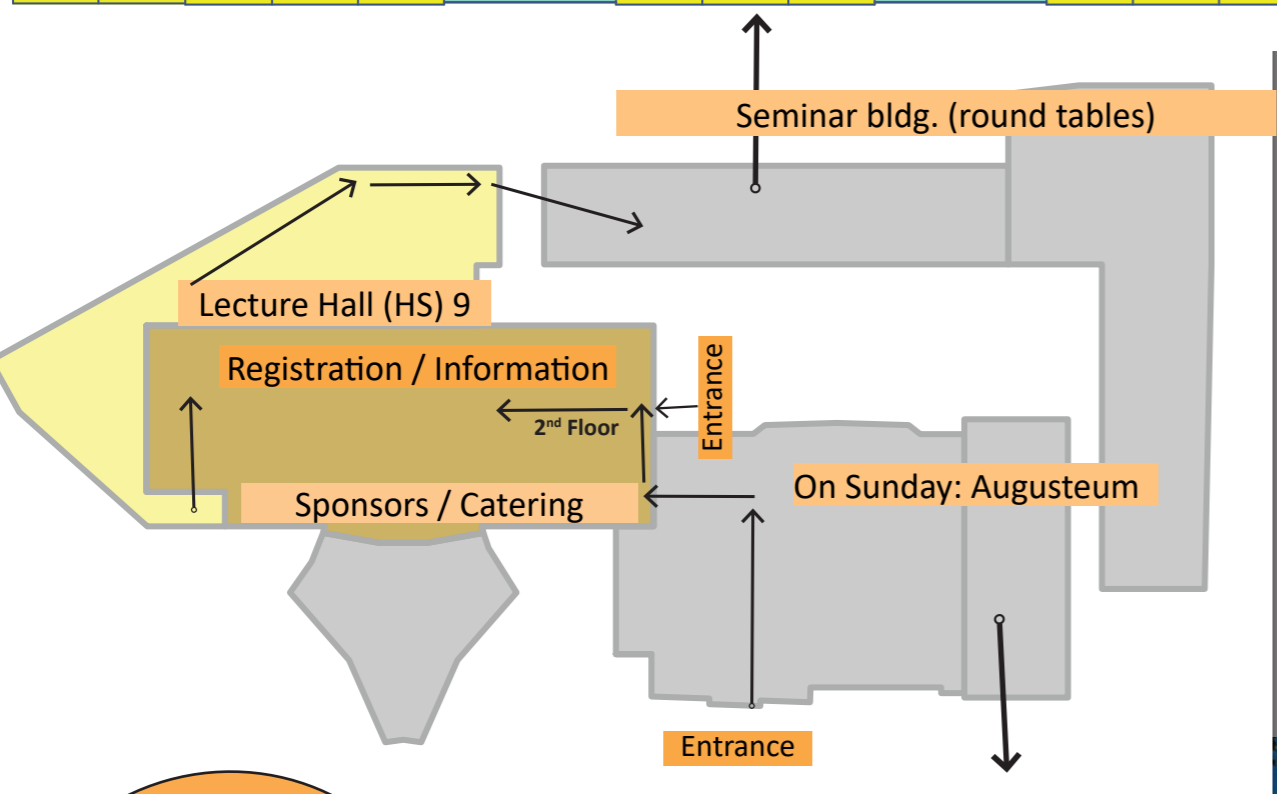

How to reach Gondwanaland from University of Leipzig by feet (23 min):

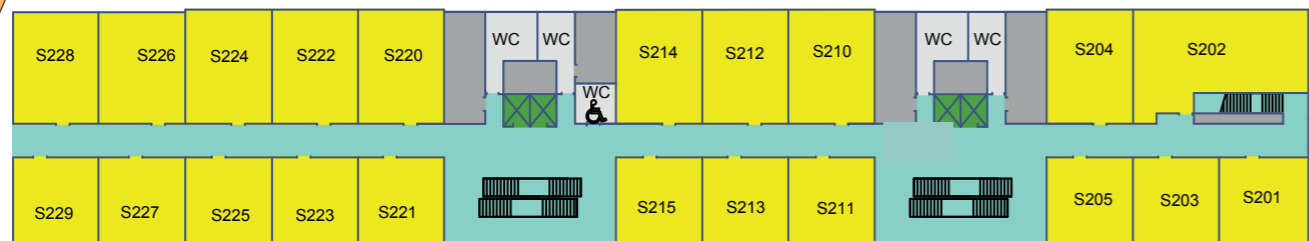

Start: conference venue
Paulinum / New Augusteum (Augustusplatz)

Then walk north and turn left onto Grimmaische Straße. Please walk straight on until you reach 'Markt' (Market). Turn right at the Markt and walk across the market square > so you reach the "Höfe am Brühl" (shopping center), you pass this building on the left side onto Richard-Wagner-Platz. Turn right in the direction of the tram station and cross the street.

Then walk straight on for about 150 m, and when you see the white dome, you have successfully reached your destination:

Gondwanaland
Address: Pfaffendorfer Straße 29, 04105 Leipzig



Program

University of Leipzig
24–28 September 2023

Welcome Reception

at Augusteum,
University of Leipzig
Sunday, from 18:30

Conference Dinner

at Gondwanaland / Zoo
Wednesday, from 19:30



Thanks for joining!

Funded by
DFG Deutsche
Forschungsgemeinschaft

Sponsors & Supporters

We cordially would like to thank our sponsors and supporters!



Program

WLAN
Network: eduinfor
Password: 64f3f-2023

SUNDAY, 24 Sept

13:00-16:00	Tutorials	Chemistry Building (description on website)
13:00	NV centers	
13:45	CIDNP	
14:30	SEOP	
15:15	Lab Tour	
From 15:00	Registration	Augusteum
17:00	Opening	Paulinum
17:20	W. Warren	
18:00-21:00	Welcome reception	Augusteum



MONDAY, 25 Sept.

Lecture hall building

9:00	J. P. Anserment (P)	Lecture Hall 9
9:40	C. Tegenkamp	
10:00	M. Levitt	Foyer, 2 nd Floor
10:20	Coffee Break	
10:40	D. Budker (I)	Lecture Hall 9
11:10	J. Eills	
11:30	V. V. Tellki	
11:50	S. Glöggler	Foyer, 2 nd Floor
12:10	Lunch break	
Round Tables I		
14:00	5 Round Tables 5 x 20 min	Seminar building
15:40	Coffee Break	Foyer, 2 nd Floor
16:10	5 Round Tables 4 x 20 min	Seminar building
17:30	A. Parker (I)	Lecture Hall 9
17:50	J. Kempf (Bruker)	Lecture Hall 9
18:10	free evening	

TUESDAY, 26 Sept.

Lecture hall building

9:00	M. Lerche (P)	Lecture Hall 9
9:40	H. Heise	
10:00	C. Bocquet	Foyer, 2 nd Floor
10:20	Coffee Break	
10:40	J. Wild (I)	Lecture Hall 9
11:10	D. Kurzbach	
11:30	S. Björgvinsdóttir	
11:50	L. Chuchkova	Foyer, 2 nd Floor
12:10	Lunch break	
Round Tables II		
14:00	5 Round Tables 5 x 20 min	Seminar building
15:40	Coffee Break	Foyer, 2 nd Floor
	City tours	

General information for Round Table presentations:

5 min talk (PowerPoint),
12 min discussion,
3 min room change =
20 min slots
Round Table presentations
will take place in the seminar
rooms.

WEDNESDAY, 27 Sept.

Lecture hall building

9:00	T. Prisner (P)	Lecture Hall 9
9:40	O. Lafon	
10:00	A. Capozzi	Foyer, 2 nd Floor
10:20	Coffee Break	
10:40	Y. Matsuki (I)	Lecture Hall 9
11:10	W. Kilian	
11:30	O. Ouari	
11:50	T. Biedenbänder	Foyer, 2 nd Floor
12:10	Lunch break	
Round Tables III		
14:00	5 Round Tables 5 x 20 min	Seminar building
15:40	Coffee Break	
16:10	5 Round Tables 4 x 20 min	Seminar building
17:30	P. Hore (P)	Lecture Hall 9
19:30-23:00	Conference Diner at Gondwanaland / Zoo	

THURSDAY, 28 Sept.

Lecture hall building

9:30	F. Mentik-Vigier (I)	Lecture Hall 9
10:00	N. Yanai	
10:20	Coffee Break	Lecture Hall 9
10:40	S. Cavagnero (I)	
11:10	S. Jannin	Lecture Hall 9
11:30	D. B. Bucher	
11:50	Goodbye	
12:10	End of the conference	

Legend

(P) = Plenary
(I) = Invited Talk

Photos

unsplash.com
pixabay.com

